

Wiring Diagram

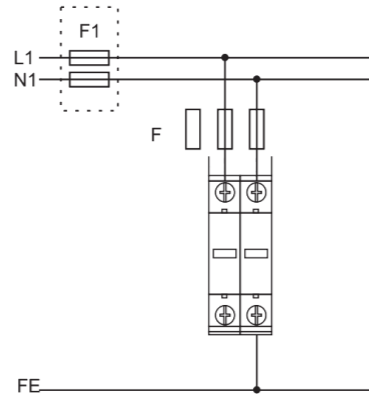

Dimension

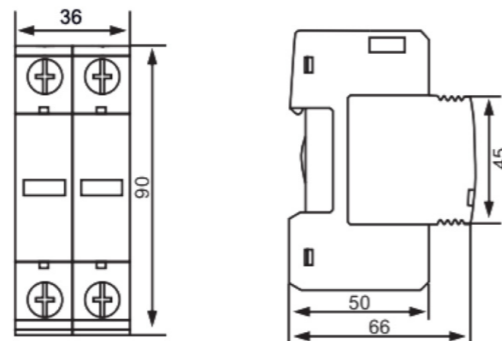

Application

This series of fuses are suitable for AC 50-60 Hz , rated voltage up to 690V and rated current up to 32a . It is mainly used as short circuit protection (GG / GL) of electrical circuit and can also be derived into semiconductor equipment-and its complete assembly of short circuit protection (AR) and motor short circuit protection (AM) . The rated breaking capacity of this series of fuses is up to 50KA.



Specifications

Product Model	RT18-32X
Pole	1P
Colour	White/blue
Rated Current (A)	2, 4, 6, 8, 10, 12, 16, 20, 25, 32
Rated Voltage(V)	500
Breaking capacity(kA)	50
Installation	Rail installation
Fuse link size(mm2)	10*38

Features

1. Din35 Rail Installation,Easy to Install
2. Adjustable terminal block,Wiring firm
3. Fire-retardant shell,high temperature resistance
4. Flexible installation,Easy to replace

Installation

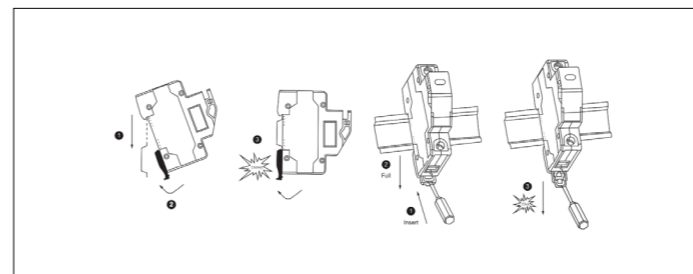

Replacement fuse

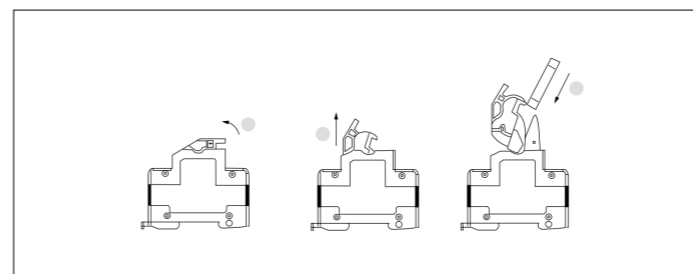

Dimension

